

Ground Floor
Approx 68 sq m / 736 sq ft

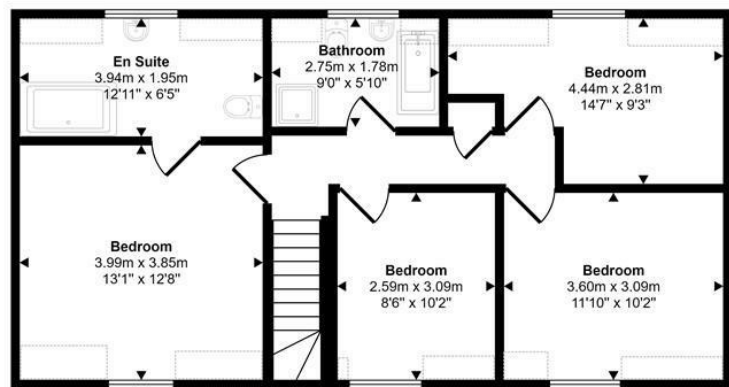

First Floor
Approx 69 sq m / 743 sq ft

Denotes head height below 1.5m

This floorplan is only for illustrative purposes and is not to scale. Measurements of rooms, doors, windows, and any items are approximate and no responsibility is taken for any error, omission or mis-statement. Icons of items such as bathroom suites are representations only and may not look like the real items. Made with Made Snappy 360.

GENERAL INFORMATION

VIEWING: STRICTLY BY APPOINTMENT ONLY via the Agents.

TENURE: We are advised Freehold

SERVICES: We have not checked or tested any of the services or appliances at the property.

TAX: Band

FACEBOOK & TWITTER

Be sure to follow us on Twitter: @ WWProPs

<https://www.facebook.com/westwalesproperties/>

Any floorplans provided are included as a service to our customers and are intended as a GUIDE TO LAYOUT only. Dimensions are approximate. NOT TO SCALE.

CFP/REM/07/24 OK

WE WOULD LIKE TO POINT OUT THAT OUR PHOTOGRAPHS ARE TAKEN WITH A DIGITAL CAMERA WITH A WIDE ANGLE LENS. These particulars have been prepared in all good faith to give a fair overall view of the property. If there is any point which is of specific importance to you, please check with us first, particularly if travelling some distance to view the property. We would like to point out that the following items are excluded from the sale of the property: Fitted carpets, curtains and blinds, curtain rods and poles, light fittings, sheds, greenhouses - unless specifically specified in the sales particulars. Nothing in these particulars shall be deemed to be a statement that the property is in good structural condition or otherwise. Services, appliances and equipment referred to in the sales details have not been tested, and no warranty can therefore be given. Purchasers should satisfy themselves on such matters prior to purchase. Any areas, measurements or distances are given as a guide only and are not precise. Room sizes should not be relied upon for carpets and furnishings.

COMPUTER-LINKED OFFICES THROUGHOUT WEST WALES and Associated office in Mayfair, London

9 Dark Gate, Carmarthen, Carmarthenshire, SA31 1PT

EMAIL: carmarthen@westwalesproperties.co.uk

TELEPHONE: 01267 236655



3 Stockwell Forge, Kidwelly, SA17 4AZ

- DETACHED HOUSE
- MASTER BENFITTING FROM EN-SUITE
- REAR GARDEN
- CUL-DE-SAC LOCATION
- HEATING - OIL
- FOUR DOUBLE BEDROOMS
- OFF ROAD PARKING
- DETACHED SUMMER HOUSE IN GARDEN
- CLOSE TO LOCAL AMENITIES
- EPC - D

Offers In The Region Of £365,000

COMPUTER-LINKED OFFICES THROUGHOUT WEST WALES and Associated office in Mayfair, London

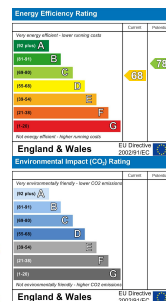

9 Dark Gate, Carmarthen, Carmarthenshire, SA31 1PT

EMAIL: carmarthen@westwalesproperties.co.uk TELEPHONE: 01267 236655

The Agent that goes the Extra Mile



